

# ecostrad

INSTRUCTION MANUAL

## **Ecostrad Fina-E** **Electric Towel Rail** Installation Manual



CE

# 1 | Warnings & Precautions

**Please read these instructions thoroughly before commencing installation.**

**Please check that all ancillary components are present and that the product has not suffered any damage during transit. Make sure you are entirely happy with the size, design and finish before starting installation.**

Installation should be carried out by a qualified professional or other fully competent person and in accordance with the relevant British and European standards (EN60335:2008, EN12828:2003, EN12831:2003 and EN14336:2004), and all applicable Building Regulations.

This towel rail has been pre-filled and adjusted for electrical standalone use. No filling is required. Do not remove any of the seals as this might cause leakages and void the warranty.

- When drilling or fixing into walls, floors or ceilings it is essential you check for pipes and wires before commencing. Please ensure that you wear all necessary personal protective equipment.
- Always switch off the electricity supply at the mains during installation, cleaning and maintenance.
- Make sure that the voltage indicated on the rating label for this appliance corresponds to your power outlet.
- Electrical safety is guaranteed only if the element is connected to a suitably earthed electricity supply, according to the regulations in force.
- Do not use the device if you detect damage to the supply cable. If the supply cable is damaged, it must be replaced by the manufacturer, its service agent or similarly qualified persons to avoid a hazard.
- The wires must be connected in an electrical connection box which complies with applicable standards.
- The towel rail will get very hot so it is not suitable for use in locations where this could cause a hazard, such as places where infirmed persons or young children will be present unsupervised.
- The element must be permanently connected to a suitable electricity supply using the cable provided. The connection should be made via a fused spur in accordance with IEE wiring regulations. If sited in a bathroom, the fused connection unit must be located out of the reach of persons using the sink, shower or bath.

## 2 | Installation

### 2 – 1 | Components

- 4 x Wall Plugs
- 4 x Bracket Bases
- 4 x Washers
- 4 x Wall Screws
- 4 x Bracket Stems
- 4 x Bracket Fronts
- 4 x Bracket Screws
- 4 x Mini Screws
- 4 x Cover Caps
- 1 x Towel Rail
- 1 x Heating Element \*

\* Basic and thermostatic models come with the element pre-fitted. Smart models come with the element sent separately, for installation by a professional electrician.

### 2 – 2 | Wall Mounting

1. Check that the wall is strong enough to hold the weight of the pre-filled towel rail. On plasterboard walls we strongly recommend fixing to the timbers. The Wall Plugs supplied are only suitable for solid walls and you will need alternative fixings for other wall types.
2. Mark your preferred bracket positions on the wall and drill holes for the Wall Plugs or whichever alternative fixings you intend to use.
3. Screw the Bracket Bases to the wall using the Washers and Wall Screws provided.
4. Loosely fit the Bracket Stems to the towel warmer with the Bracket Fronts and Bracket Screws.
5. Align the Bracket Stems with the Bracket Bases and push the towel warmer back into position.

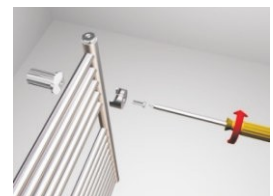
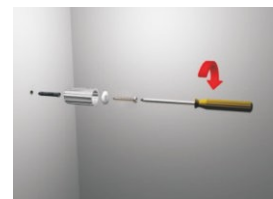

6. Tighten the Bracket Screws with a screwdriver.

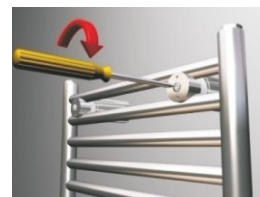

7. Insert the Mini Screws into the Bracket Bases and tighten with a screwdriver to lock the bracket into position.



8. Push the Cover Caps into position on the Bracket Fronts.

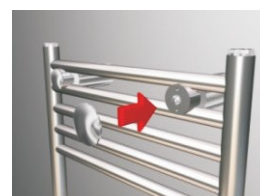

## **2 – 3 | Connecting the Towel Rail**

Wiring the heating element to the mains is a job for a qualified electrician. Please consult the element manual for full instructions and safety warnings.

Please note: the heating element must always be located at the bottom of the rail. DO NOT fit the element at the top.

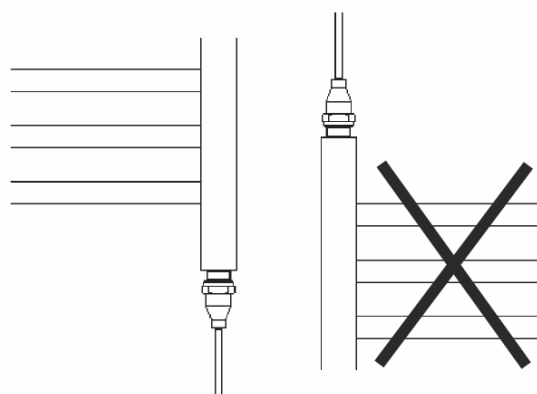

## **3 | Cleaning**

Regular cleaning with a soft cloth will keep the surface of your product looking new. Soapy water can be used to remove stubborn marks. Do not use abrasive or chemical cleaners as these will damage the surface finish over time.

## **4 | Warranty**

The Ecostrad Fina-E carries a 5-year guarantee on the steel body and a 3-year guarantee on paintwork. Within the stated period, starting from the date the customer receives their unit, Ecostrad guarantee to repair or replace the unit where a fault is due to defects in materials or manufacturing. Please refer to the element manual for details of the warranty on electrical components.

The warranty does not cover any defect arising from damage, negligence, usage outside the product's intended purpose or fair wear and tear. The warranty is only valid when the towel warmer has been used with the supplied heating element, at the specified supply voltage, and in accordance with all conditions specified in this manual. The warranty will be void if the towel warmer has been tampered with, if its fluid levels have been adjusted, or if the ratings label has been removed.

The warranty does not cover failures and faults due to force majeure, accidental damage, mishandling, external impact, chemical agents or atmospheric phenomena, incorrect use of the unit, the purchaser's faulty electrical installations, transporting the unit or problems caused by the unit being handled by persons not authorised by Ecostrad. An invoice may be required to confirm that installation work has been carried out by a qualified professional. Ecostrad cannot accept responsibility for damage, loss or injury caused by incorrect installation, maintenance, cleaning or covering the unit.

The warranty is a contract with the original purchaser and does not transfer if the unit is re-sold, gifted or inherited. Proof of purchase, including order number and order confirmation or invoice, will be required if a claim is made. The warranty covers only the model shown on the purchase invoice. The warranty covers the repair or replacement of the defective product only and Ecostrad shall have no liability for installation costs or consequential losses however incurred. Claims must be made with the establishment where the unit was purchased. This warranty does not affect the customer's consumer rights.

## 5 | Disposal



The icon with the crossed-out waste bin on electrical or electronic equipment stipulates that this equipment must not be disposed of with household waste at the end of its life. You will find collection points for free return of waste electrical and electronic equipment in your vicinity. The addresses can be obtained from your local authority.

The separate collection of waste electrical and electronic equipment enables the re-use, recycling and other forms of recovery of waste equipment, and prevents any negative effects for the environment or human health caused by the disposal of hazardous substances potentially contained in the equipment.